

Typ: KSA.B
(Alu-Konter-Umbauschwelle)

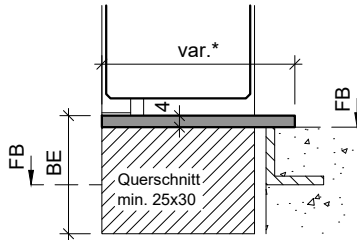

* Standard 60/80/100

Typ: KSA.B
(Alu-Konter-Schwelle)
Breite = Rahmendicke

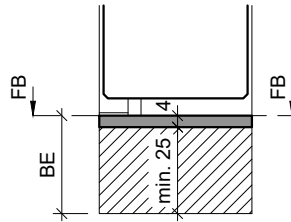

Typ: KSR.B
(Alu-Konter-Umbauschwelle)

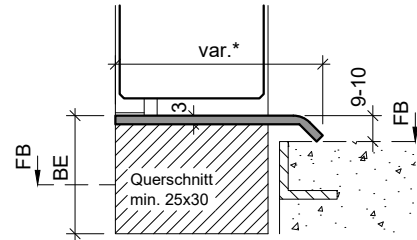

* Standard 65/75/85/100

Typ: KSP.B (Sonderanfertigung)
(Konter-Abdeckprofil)
Edelstahl
Breite = Rahmendicke

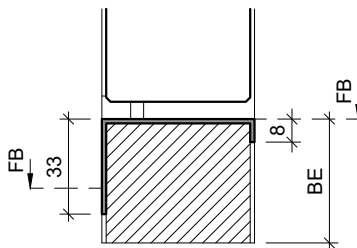

Typ: SP25
(Abdeckprofil)
Edelstahl

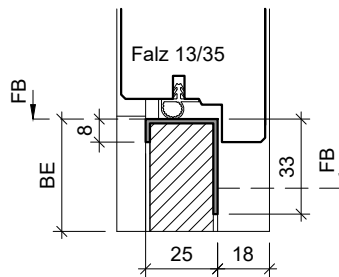

Typ: V-SP25
(Abdeckprofil)
Edelstahl

