

Holzrahmen aus Hartholz Typ RDS17-48,
 als Blend- oder Blockrahmen (gründiert oder lackiert)
 auf resp. zwischen MBW oder LBW montiert.

Kombinierbar mit Türen von 38-41mm Dicke:	
DB/40(A)	Schallhemmend, o./m. Alu, 40mm
HGL/40	Holz/Glastür, 40mm
RS/40(A)	Röhren-Vollspan, o./m. Alu, 40mm
VS/40(A)	Vollspan, ohne/mit Alu, 40mm

Weitere Schwellenprofile: siehe Zeichnung Nr. 10096

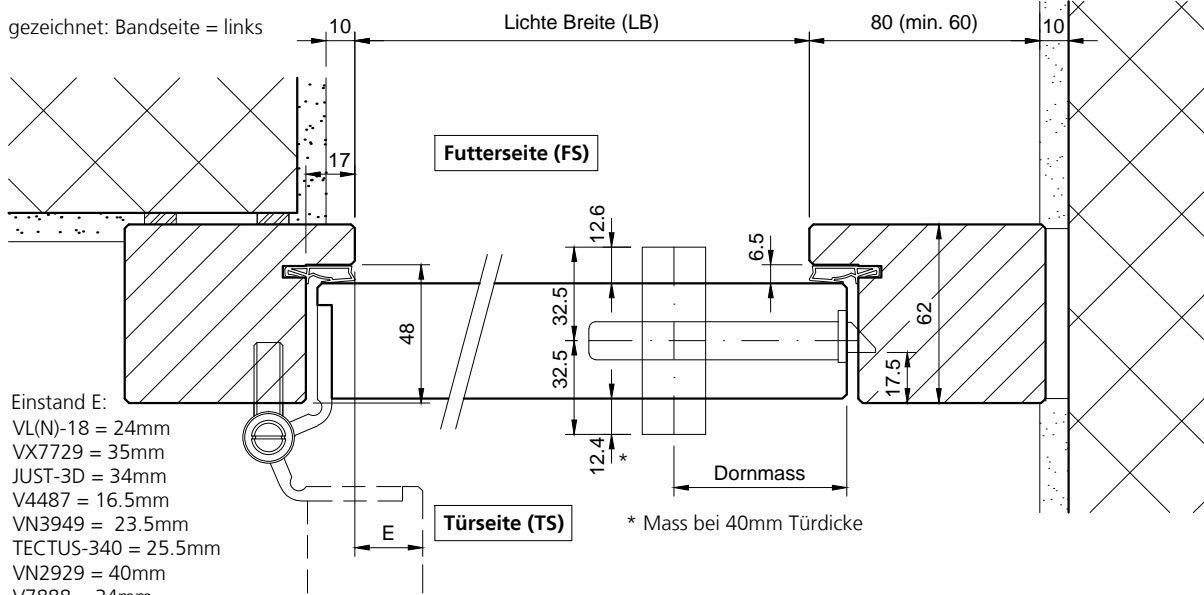
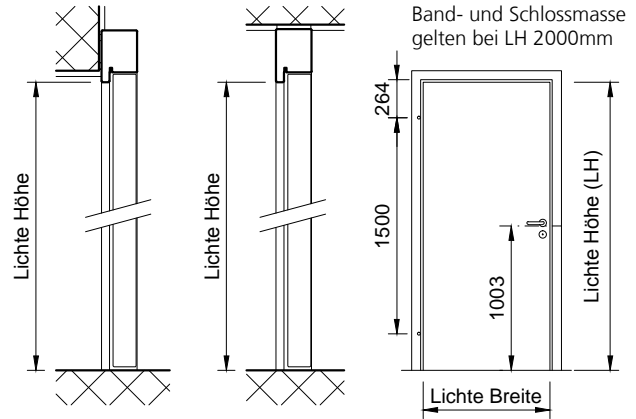

- Einstand E:
 VL(N)-18 = 24mm
 VX7729 = 35mm
 JUST-3D = 34mm
 V4487 = 16.5mm
 VN3949 = 23.5mm
 TECTUS-340 = 25.5mm
 VN2929 = 40mm
 V7888 = 34mm
 VN2927 Compact Planum = 36mm

Typ: SW
(Schwellenwinkel)

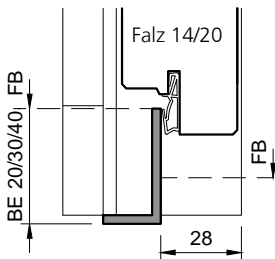

Typ: SW
(Schwellenwinkel)

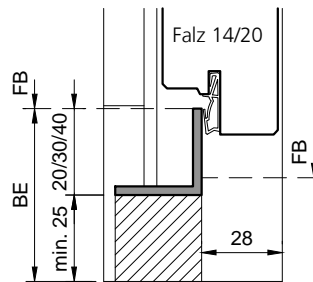

Typ: SA
(Alu-Umbauschwelle)

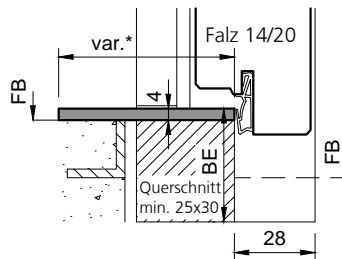

* Standard 60/80/100

Typ: VH
(prov. Verbindung)

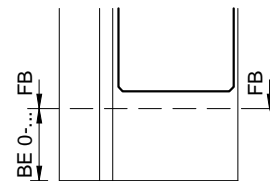

Typ: KSW.B
(Konterschwelle)

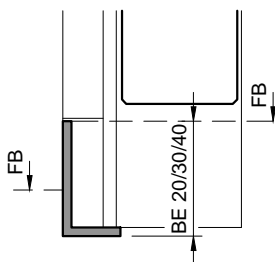

Typ: KSW.B
(Konterschwelle)

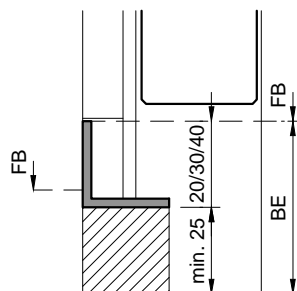

Typ: SR
(Alu-Umbauschwelle)

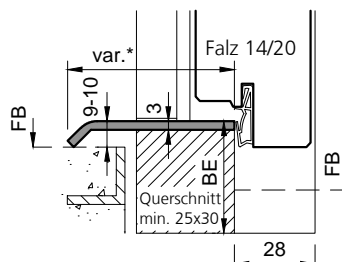

* Standard 65/75/85/100

Typ: UML
(Profil 4-seitig umlaufend)

