

**Typ: KSA.B**  
(Alu-Konter-Umbauschwelle)

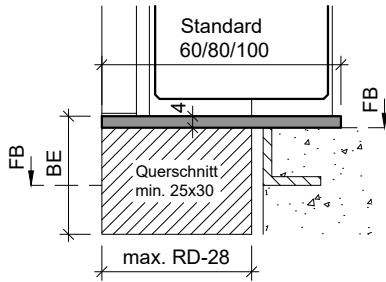

**Typ: KSA.B**  
(Alu-Konter-Schwelle)  
Schwellenbreite = Holzdicke

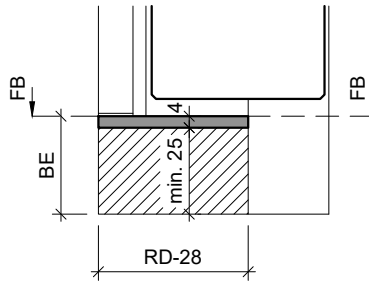

**Typ: KSR.B**  
(Alu-Konter-Umbauschwelle)

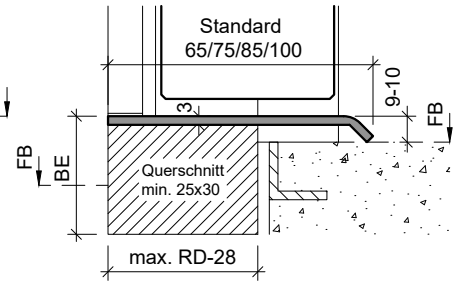

**Typ: KSP.B (Sonderanfertigung)**  
(Konter-Abdeckprofil)  
Edelstahl

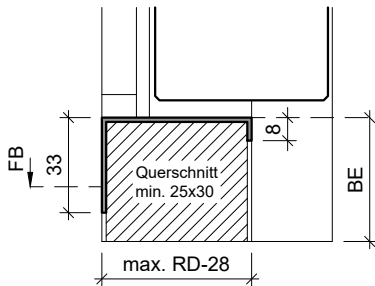

**Typ: SP33**  
(Abdeckprofil)  
Edelstahl

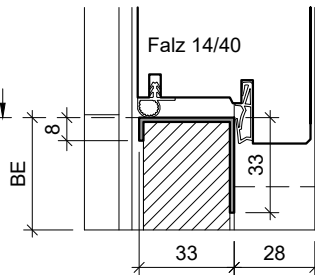

**Typ: V-SP33**  
(Abdeckprofil)  
Edelstahl

