

Typ: KSA.B
(Alu-Konter-Umbauschwelle)

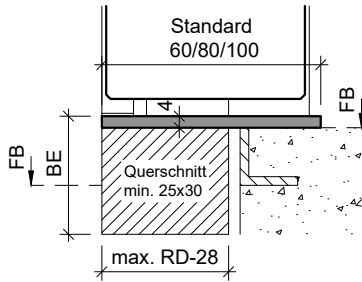

Typ: KSA.B
(Alu-Konter-Schwelle)
Schwellenbreite = Holzdicke

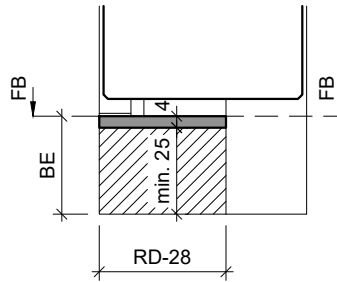

Typ: KSR.B
(Alu-Konter-Umbauschwelle)

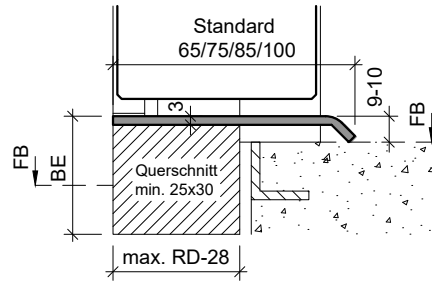

Typ: KSP.B (Sonderanfertigung)
(Konter-Abdeckprofil)
Edelstahl

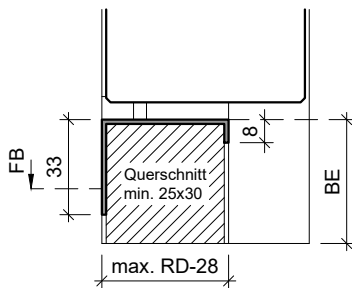

Typ: SP33
(Abdeckprofil)
Edelstahl

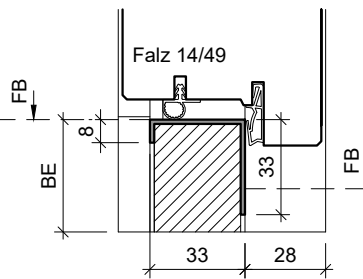

Typ: V-SP33
(Abdeckprofil)
Edelstahl

