

VL(N)-18 (SZ/HR)

blau/weiss verzinkt oder matt vernickelt

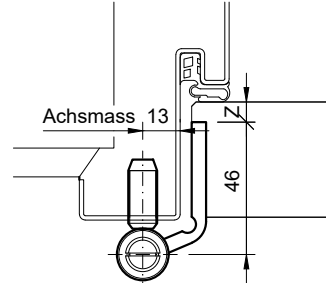
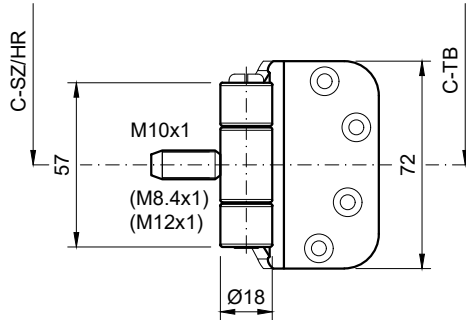

Blockfutter-Breite: min. 45mm

BK-18 (SZ/HR)

blau/weiss verzinkt

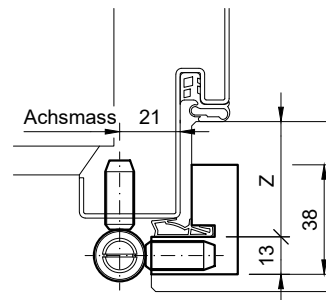
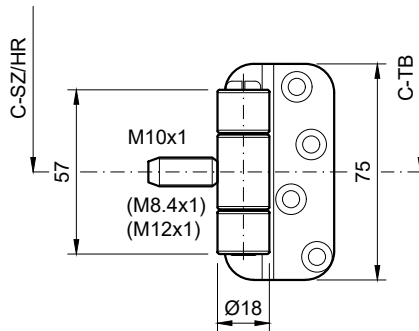

BK8026 (SZ/HR)

blau/weiss verzinkt

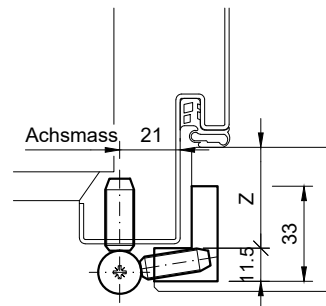
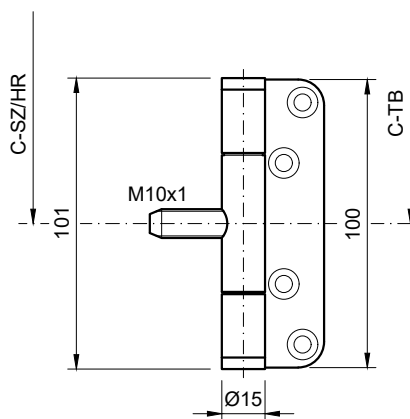

SZ = Stahlzargen, HR = Holzrahmen, HZ = Holzzargen