

**Bandseite (oder links bei 2-flügelig)**

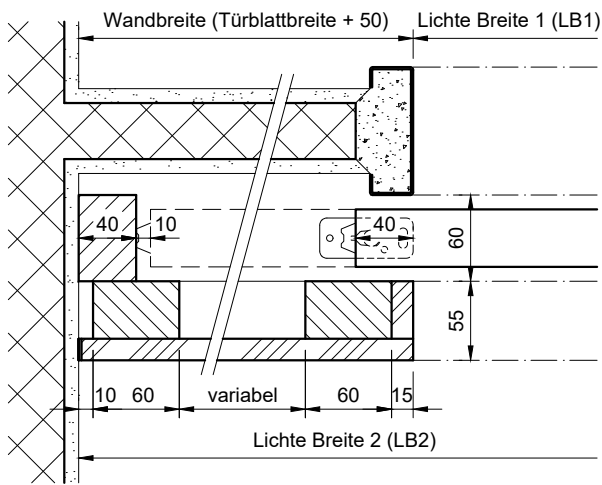

**Schlosseite, Detail (S1)**

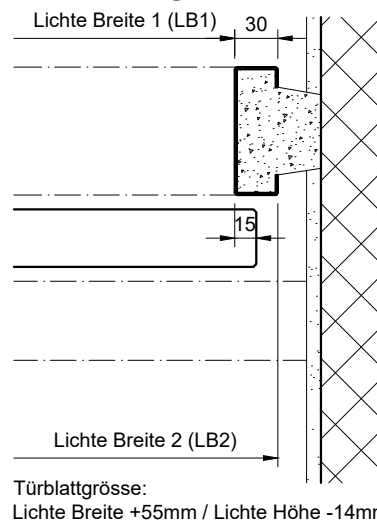

**Schlosseite, Detail (S4)**

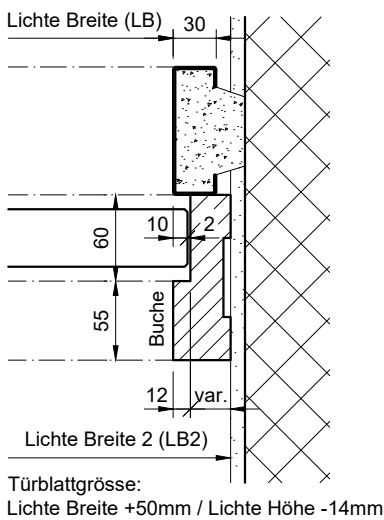

**Schlosseite, Detail (S5)**

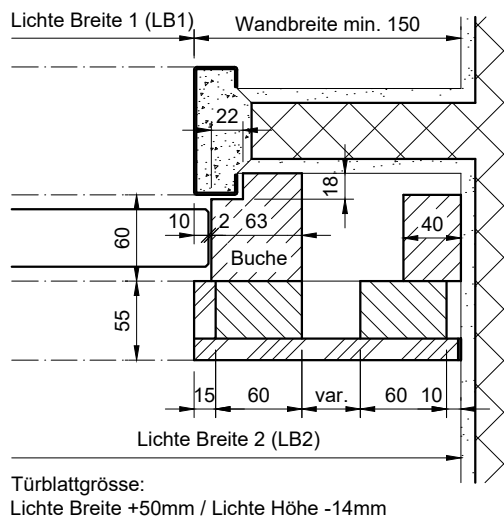

**Schlosseite, Detail (S6)**

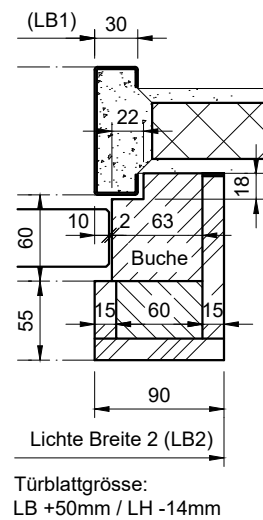

**beidseitig Wand (2-flügelig oder Detail S5)**

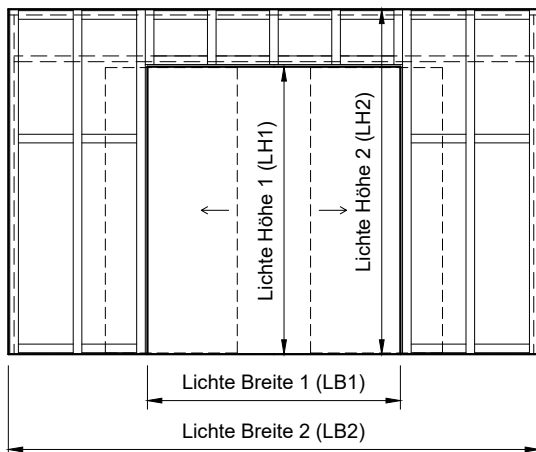

**rechts, 2-flügelig, Detail (Z5)**

