

Holzrahmen Typ RDS14-31, als Blend- oder Blockrahmen auf resp. zwischen MBW oder LBW montiert.

Kombinierbar mit Türen von 40mm Dicke bis 45/60 kg:

DB/40(.A)	Schallhemmend, o./m. Alu, 40mm	ca. 27 kg/m ²
RS/40(.A)	Röhren-Vollspan, o./m. Alu, 40mm	ca. 19 kg/m ²
VS/40(.A)	Vollspan, ohne/mit Alu, 40mm	ca. 25 kg/m ²

gezeichnet: Bandseite = links

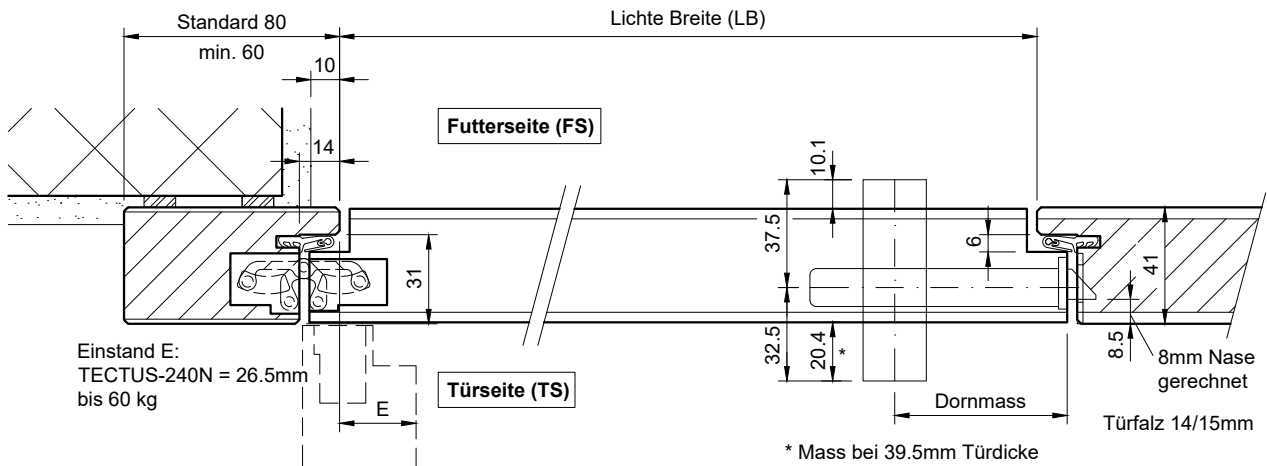
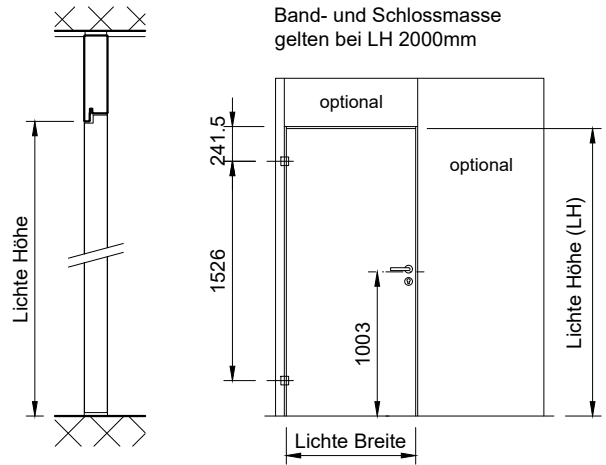

Option:

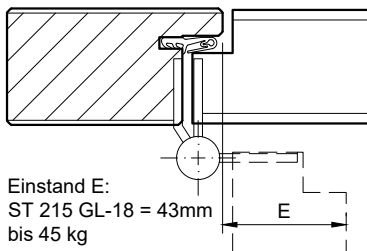

Typ: SW
(Schwellenwinkel)

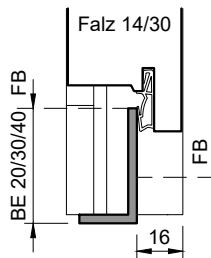

Typ: SW
(Schwellenwinkel)

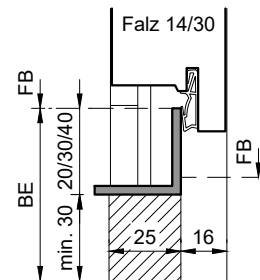

Typ: VH
(prov. Verbindung)

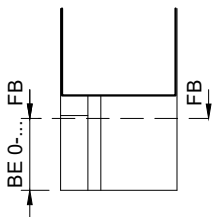

Typ: KSW.B
(Konterschwelle)

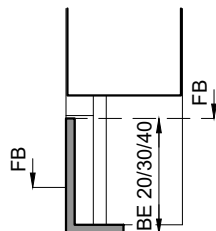

Typ: KSW.B
(Konterschwelle)

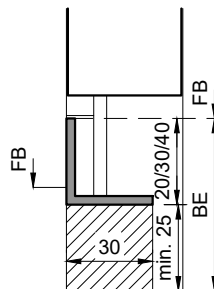

Typ: UML
(Profil 4-seitig umlaufend)

